

Expert Support For Passive Fire Protection

Passive Fire Protection, also known as Built Fire Protection, plays a significant role in safeguarding people, as well as limiting fire and smoke damage to buildings and contents.

It's a vital part of your fire safety strategy – and, as a building's owner or manager, legislation puts the responsibility for compliance in your hands.

How does Passive Fire Protection work?

Passive Fire Protection works in conjunction with Active Fire Protection (sprinklers, extinguishers etc) by separating your building into areas of manageable risk or 'compartments'. These areas restrict the growth and spread of fire, so occupants can escape and firefighters are protected.

- Limits the spread of fire, heat and smoke by containing it
- Protects escape routes and allow for escape time
- Protects the building structure and assets, to enhance its sustainability

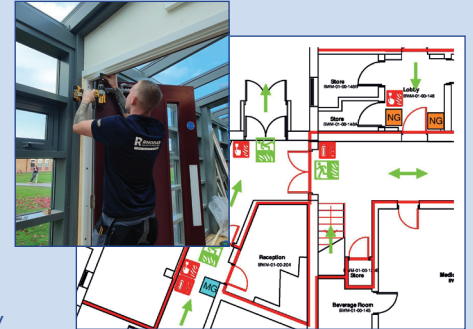

Passive Fire Protection in place

The typical key areas where Passive Fire Protection products are required within a property are illustrated below.

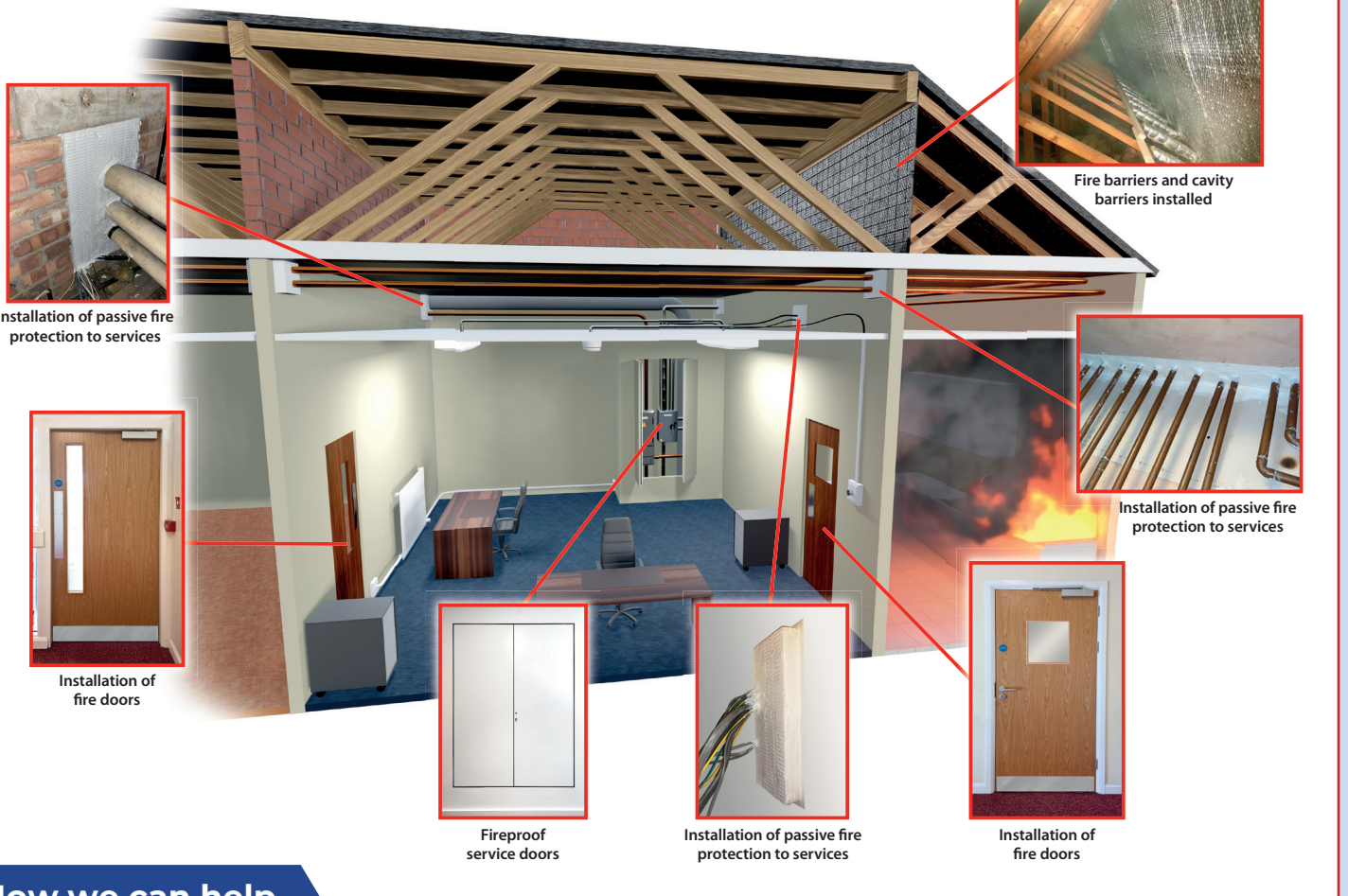

How we can help

Rhodar's specialist team can add Passive Fire Protection products to your building as a stand-alone service or as part of asbestos abatement works. We work for a wide range of sectors including **education, healthcare, transport, commercial** and **residential** buildings.

Contact us on: enquiries@rhodar.co.uk or 0800 834 669

Expert services for your building's Passive Fire Protection

All of our services are carried out in conjunction with fire compartmentation drawings and risk assessments or surveys:

Service Penetrations

Open voids created from service penetrations (such as pipe, cable trays and duct work



etc) in walls, ceilings and floors are sealed within fire compartmentation. We use a range of approved products including intumescent mastics, ablative batts, fire barriers and fire compounds.

Fire Door Installation & Maintenance

New fire door sets are installed within your property. All fire door sets will be installed as per the 'global assessment' and quality checked by one of our supervisors prior to us issuing final certification.



Fire & Cavity Barriers

Fire barriers and cavity barriers are installed in open voids. This is a proven and cost-effective alternative to the common fire batts and fire walls themselves.



Fire Compartmentation Survey

This involves a detailed survey of the building's fire compartmentation, followed up by a report of the findings via the Onetrace app, with a marked-up drawing and a description of the breaches within the fire compartments – including service penetrations, fire doors and fire barriers, plus much more.

We utilise the **Onetrace Project Management system** to track and record every job we undertake. This provides clients with the Operation & Maintenance Manual (O&M) on completion of each job – providing real-time progress management of our projects.

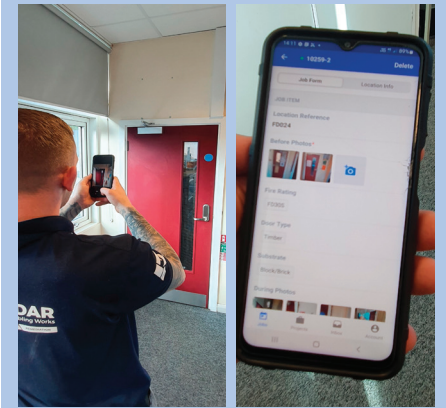

Rhodar holds FIRAS certification offering peace of mind, with all jobs recorded on the FIRAS database.



A proven partner you can trust

- **Decades of Fire Protection experience** enables our team to give you the best advice on the right Passive Fire Protection solutions for your premises.
- We only use the **highest-quality products** that are trusted for their integrity and consistent performance.



As leaders in asbestos removal, demolition and remediation, we have a proven track record of working in hazardous environments. This places us in a unique position to offer Passive Fire Protection where asbestos contamination is present, meaning you can enjoy a seamless, end-to-end service from a single trusted partner, with cost and time-saving efficiencies assured.

Contact us on: enquiries@rhodar.co.uk or 0800 834 669



Rhodar National Headquarters
Unit C, Astra Park, Parkside Lane, Leeds LS11 5SZ
www.rhodar.co.uk



IRS:GSDM:15105 ©Rhodar Ltd Issue date: April 2023

Rhodar – Passive Fire Protection Services